

POSTO ESTERNO PER IMPIANTI 1+1
DOOR UNIT FOR 1+1 SYSTEMS
POSTE EXTERNE POUR INSTALLATIONS 1+1
MICROALTAVOZ PARA SISTEMAS 1+1
SRECHHEINHEIT AUSSEN FÜR ANLAGEN 1+1

Sch./Ref. 1145/67

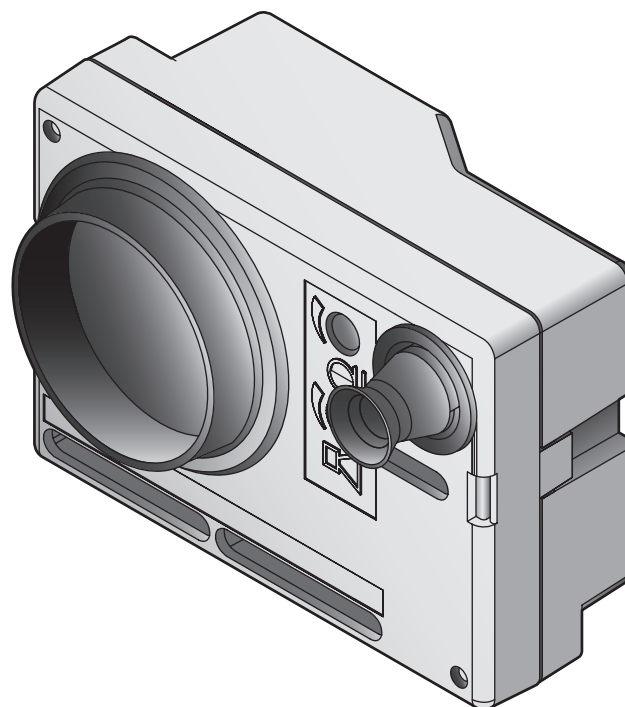

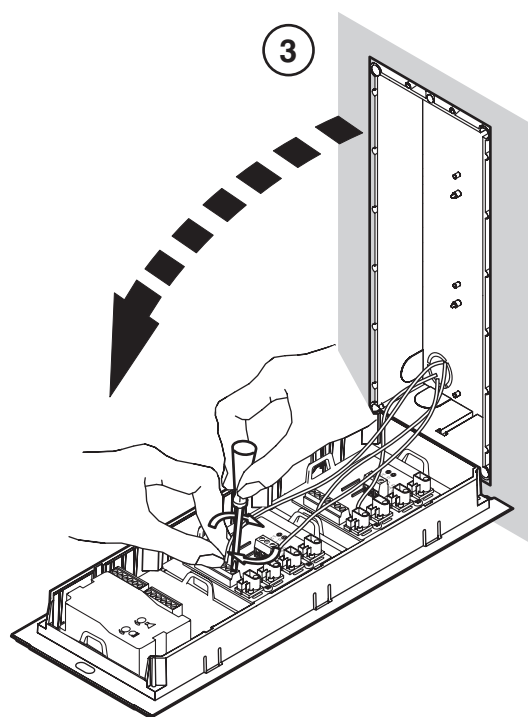
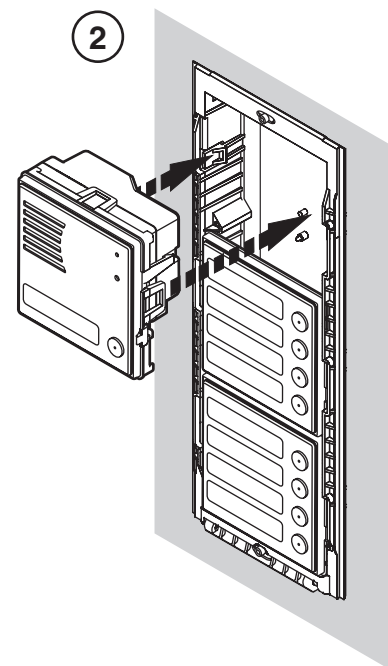
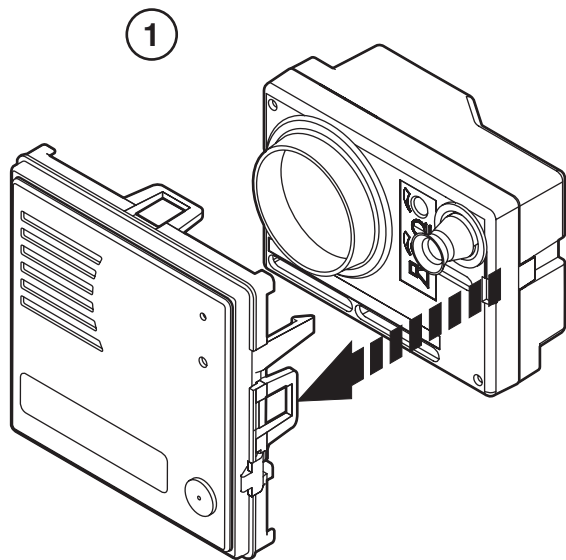

4

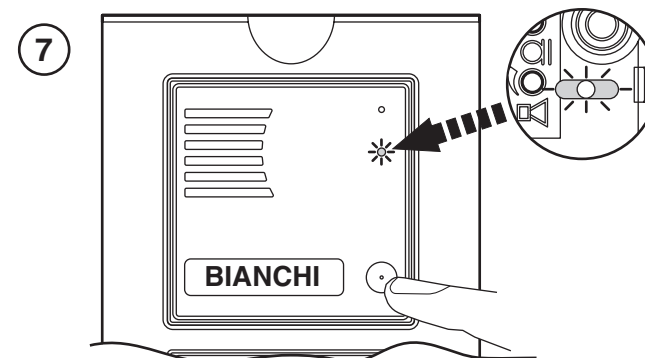
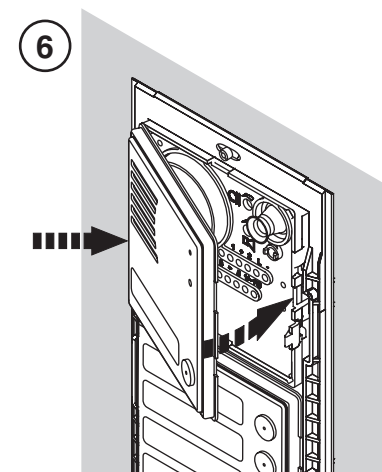
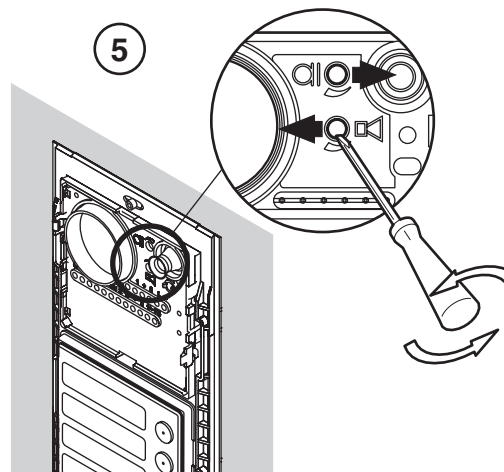
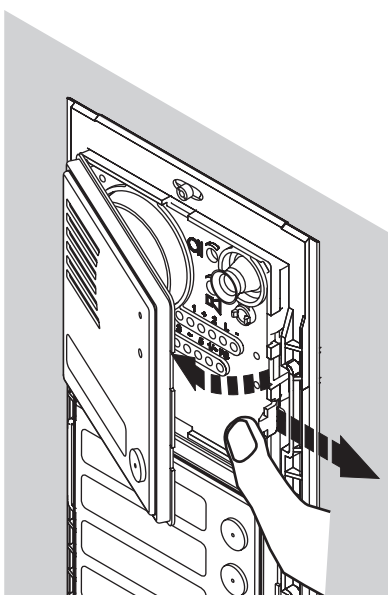

Funzione "feedback di chiamata": al momento della chiamata da un qualsiasi modulo con tasti, viene emesso dal posto esterno un segnale visivo che testimonia l'effettivo inoltro della chiamata (led lampeggiante).

"Call feedback" function: A visual signal indicating that the call is actually being placed (blinking LED) will be generated by the door unit when a call is being made by any module with buttons.

Fonction "feedback d'appel": lors d'un appel en provenance de n'importe quel module muni de touches, le poste externe émet un signal visuel témoignant l'envoi effectif de l'appel (led clignotante).

Función "feedback de llamada": en el momento de la llamada desde cualquier módulo con teclas, en el microaltavoz se genera una señal visual que demuestra el envío concreto de la llamada (led intermitente).

Funktion "Ruf-Feedback": Im Moment des Anrufs von einem beliebigen Modul mit Tasten sendet die Außenstelle ein visuelles Signal aus, das das tatsächliche Weiterleiten des Anrufs bestätigt (blinkende Led).

ATTENZIONE: tale prestazione non è disponibile su impianti con chiamata 12 Vca (Mod. 1130, Ranger, ...) e nel caso di separazione dei contatti comuni tasti (G/T).

IMPORTANT: This feature is not available in 12 Vac call systems (Mod. 1130, Ranger, etc.) and if button common contacts (G/T) are separated.

ATTENTION: cette fonction n'est pas disponible sur les installations avec appel 12 Vac (Mod. 1130, Ranger, ...) et en cas de séparation des contacts communs de touches (G/T).

ATENCIÓN: esta prestación no está disponible en sistemas con llamada 12 Vac (Mod. 1130, Ranger, ...) y en el caso de separación de los contactos comunes de las teclas (G/T).

ACHTUNG: diese Leistung ist bei Anlagen mit 12 Vac Ruf nicht lieferbar (Mod. 1130, Ranger, ...) und im Fall der Trennung der gemeinsamen Kontakte der Tasten (G/T).

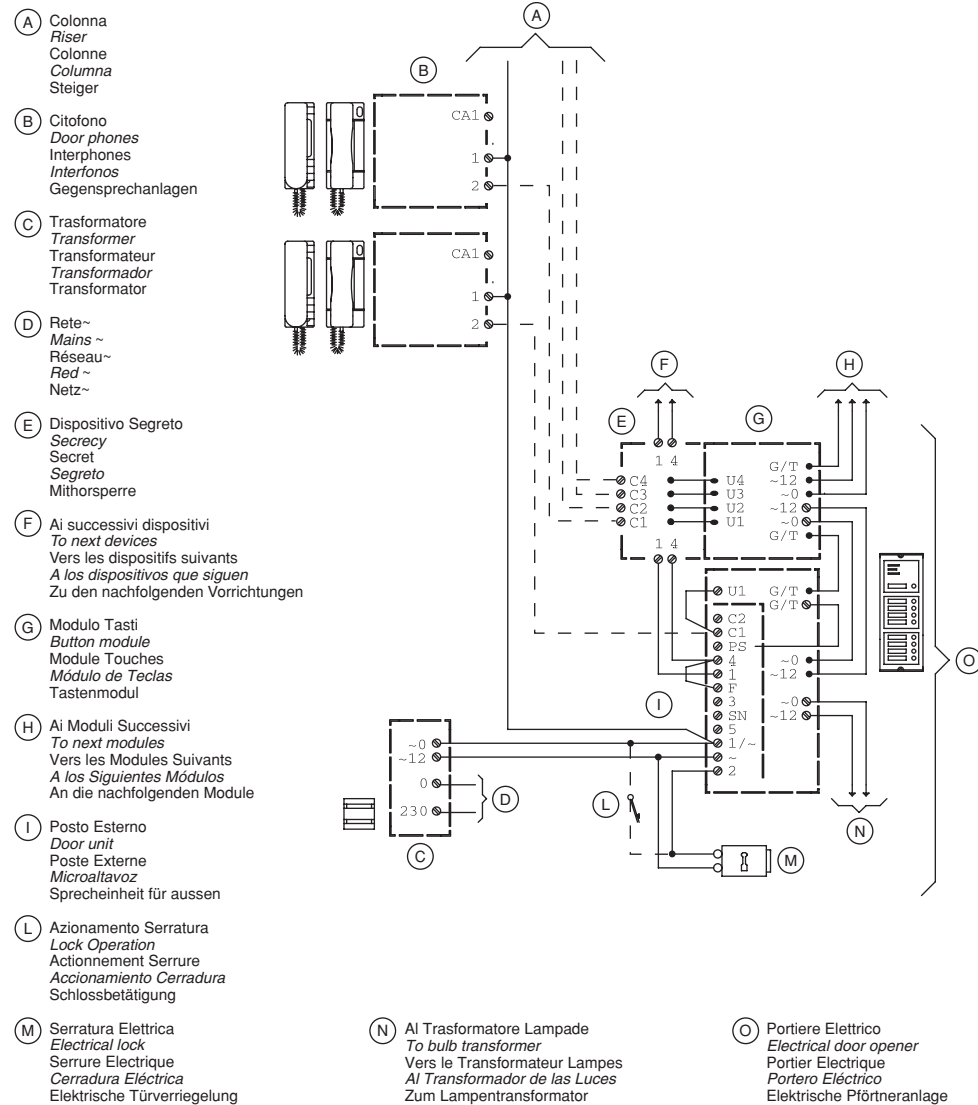

DS 1145-006A

urmet
DOMUS

LBT 7307

FILIALI

20151 MILANO - Via Gallarate 218
Tel. 02.380.111.75 - Fax 02.380.111.80
00043 CIAMPINO (ROMA) - Via L.Einaudi 17/19A
Tel. 06.791.07.30 - Fax 06.791.48.97



STABILIMENTO

URMET DOMUS S.p.A.
10154 TORINO (ITALY)
VIA BOLOGNA 188/C
Telef. 011.24.00.000 (RIC. AUT.)
Fax 011.24.00.300 - 323
Call Center 011.23.39.801